

## Steel Panelok

The Panelok system is the ideal Nut and Bolt type fastener where a low profile finish is desirable on both-sides. When installed, a high tensile splined bolt with a moisture proof seal underhead and adhesive patch on the thread match neatly with the zinc plated T-nut. Vibration and tamperproof, the assembly is optimal for metal/wood applications.

**Material:** Grade 8.8 Steel, Zinc Plated

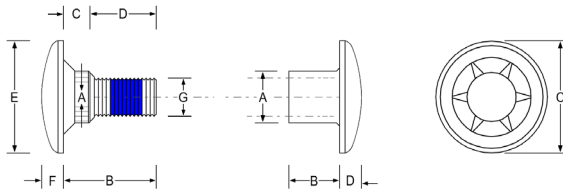

Bolt Part Code	Hole Size mm	Panelok Bolt Dimensions (mm)						G Thread	Shear kN	Tensile kN
		A mm	B mm	C mm	D mm	E mm	F mm			
APLB-1014	10.3	10.5	22.2	6.60	15.6	23.1	5.10	5/16" UNC	14.0	20.0
APLB-1016			25.4	9.50	15.9					
APLB-1020			31.8	9.50	22.3					
APLB-1024			38.5	12.3	26.2					

Nut Part Code	Panelok Nut Dimensions (mm)				Drive Bit	Suggested Torque Nm
	A mm	B mm	C mm	D mm		
APLN-1006	9.85	9.60	25.4	4.00	Torx 55	17.20
APLN-1008		12.7				
APLN-1010		15.9				
APLN-1016		25.8				

### Bolt and Nut Combinations / Grip Ranges (mm)

Bolt Code	Nut Code	Grip Range (mm) Min ~ Max	Bolt Code	Nut Code	Grip Range (mm) Min ~ Max
APLB-1014	APLN-1006	21.20 ~ 24.90	APLB-1020	APLN-1010	30.80 ~ 37.70
APLB-1014	APLN-1010	22.50 ~ 28.10	APLB-1020	APLN-1016	35.30 ~ 47.60
APLB-1016	APLN-1008	24.40 ~ 28.10	APLB-1024	APLN-1008	37.50 ~ 41.20
APLB-1016	APLN-1010	25.40 ~ 31.30	APLB-1024	APLN-1010	37.50 ~ 44.40
APLB-1020	APLN-1008	30.80 ~ 34.50	APLB-1024	APLN-1016	38.10 ~ 54.30

All diagrams and drawings are intended for illustration and measurement purposes only. Dimensions and specifications may change without prior notice. Please refer to your distributor for the most up-to-date data sheet. The test data presented offers approximate average strength values based on multiple tests conducted in various materials and thicknesses. For applications requiring precise strength figures or when the applied load approaches the published values, we strongly recommend conducting tests specific to your use case. **REVISED MARCH 2025**