

## Steel Hexagon Low Profile Rivet-Nuts

Low profile head, used in conjunction with an imperial hexagon hole to give maximum resistance to applied torque or unscrewing torque.

**Material:** Steel

**Finish:** Zinc Plated

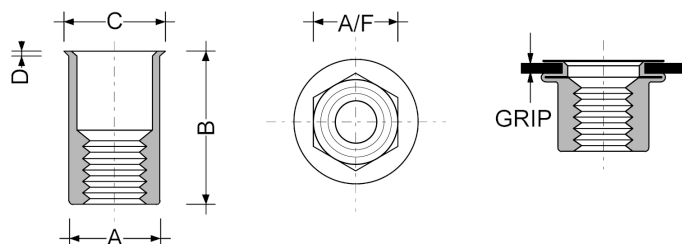

Thread Size	Part Code	Grip Range mm	Hole Size (HEX A/F) mm	A mm	B mm	C mm	D mm	Pull-Out (min) KN	Push-Out (min) KN	Maximum Torque Nm
M5	IN88-0530	0.50 - 3.00	7.20	7.10	12.0	8.10	0.50	5.90	1.90	7.90
M6	IN88-0633	0.70 - 3.30	9.60	9.50	14.5	10.5	0.50	6.90	2.40	12.4
M8	IN88-0833	0.70 - 3.30	10.6	10.5	16.0	11.5	0.50	14.8	2.80	16.4

Dimensions and specifications are subject to change without notice. Check your distributor for the latest data sheet. The test data provides approximate strength values averaged in multiple tests in various materials and thicknesses. We recommend testing your application when an exact strength figure is required, or the load to be applied comes close to the published data.  
Revised September 2023